

ROAD CLOSURE

Northbound Sepulveda Boulevard Between Imperial Hwy and Century Blvd

Sunday, April 16, 2023 from 12AM to 4AM



ACTIVITY

To facilitate wayfinding installation for the Landside Access Modernization Program, northbound Sepulveda Boulevard between Imperial Highway and Century Boulevard, including the westbound I-105 Freeway offramp at Sepulveda Boulevard, will be closed Sunday, April 16 from 12AM to 4AM (four hours). Southbound Sepulveda Boulevard is not impacted.

Vehicles will be detoured via westbound Imperial Highway to northbound Pershing Drive to eastbound Westchester Parkway.

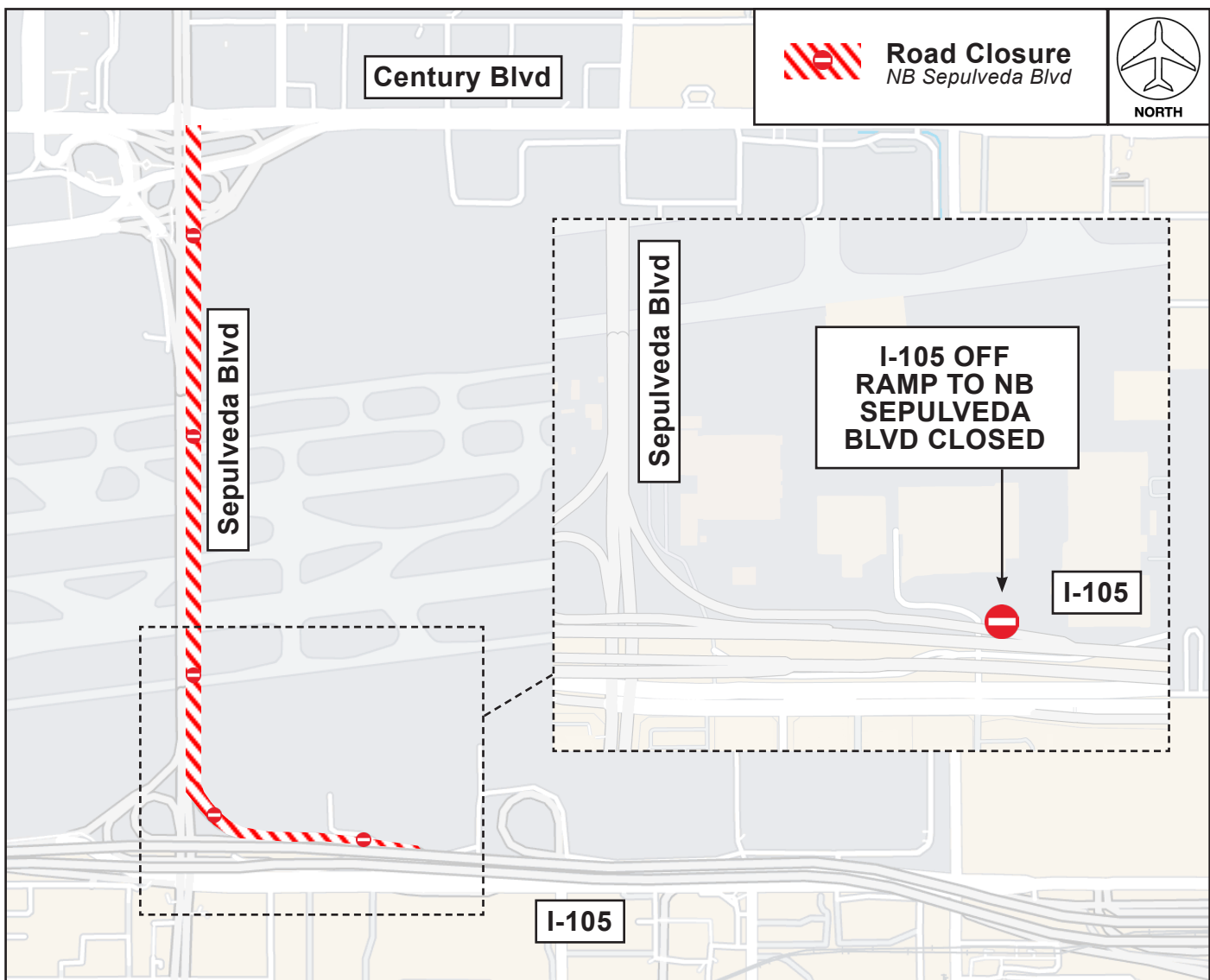

LAX Construction Hotline: 310-649-5292 | @FlyLAXAirport | LAInternationalAirport
 LAXConstructionHotline@LAWA.org