



NIGHTLY LANE CLOSURES

Southbound Sepulveda Boulevard (Two Lanes) and Sky Way Ramp

Monday, September 25 through Friday, October 13, 2023
 Nightly (Monday through Friday) from 9PM to 5AM

ACTIVITY

To facilitate pipeline repairs by Shell Gas, two lanes of southbound Sepulveda Boulevard at the Sky Way Ramp (LAX entrance), along with the Sky Way Ramp, will be closed Monday, September 25 through Friday, October 13, nightly (Monday through Friday) from 9PM to 5AM. Through traffic on southbound Sepulveda Boulevard will be maintained at all times; Sky Way Ramp traffic will be detoured to westbound 96th Street to enter the airport. Detour signage will be in place.

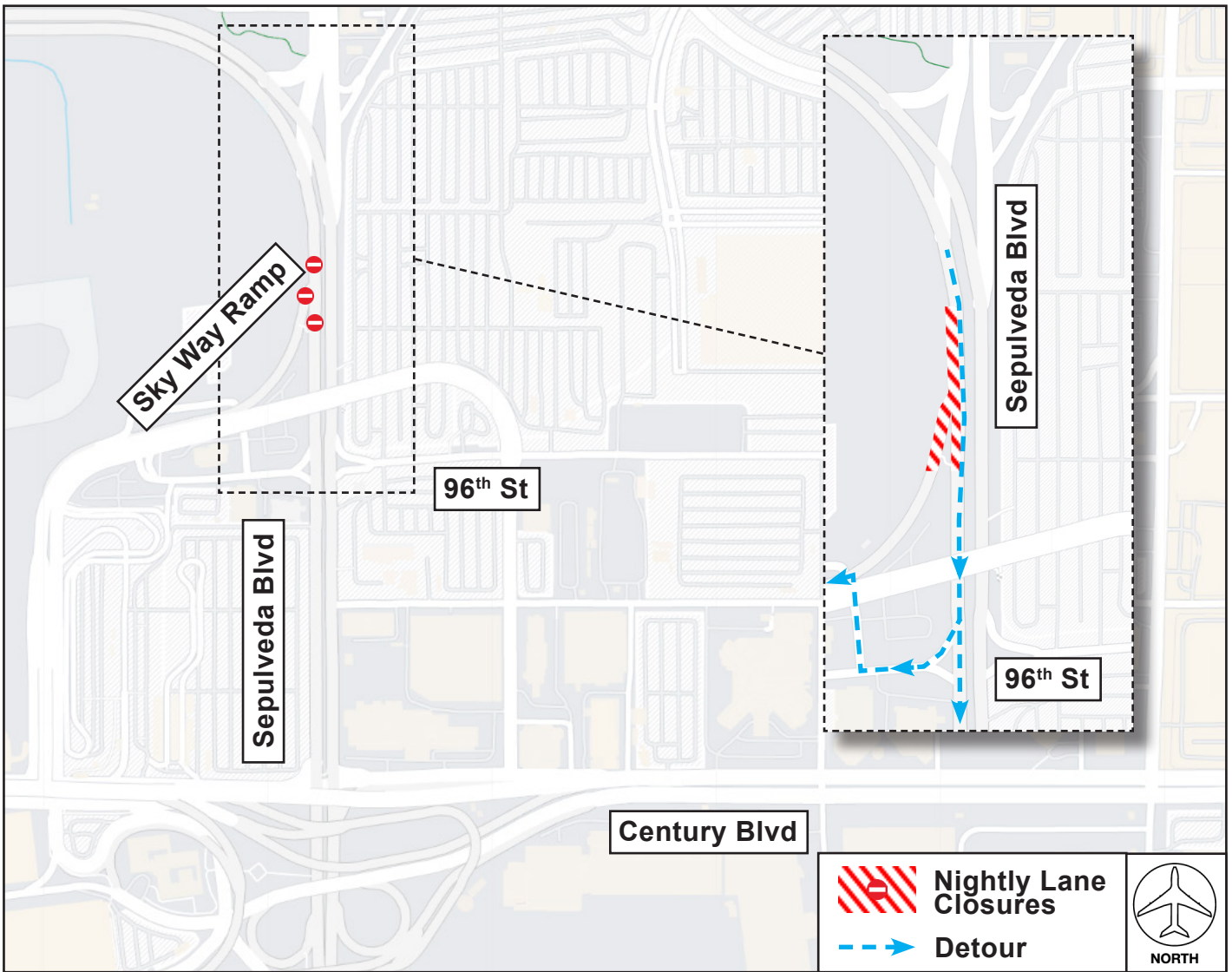

LAX Construction Hotline: 310-649-5292 | @FlyLAXAirport | LAInternationalAirport
 LAXConstructionHotline@LAWA.org