

# LANE RESTRICTIONS

## Century Boulevard and Avion Drive

*Friday, August 15 at 10PM through Monday, August 18 at 6AM*

### ACTIVITY

To facilitate roadway restoration for the Automated People Mover Project, lane restrictions will be in place on both east- and westbound lanes of Century Boulevard at Avion Drive, as well as portions of Avion Drive both north and south of Century Boulevard, beginning Friday, August 15 at 10PM through Monday, August 18 at 6AM.

Work is occurring in phases and crews will move between different traffic control and lane restriction configurations during this time. Only one direction of Century Boulevard will be restricted at a time, with at least one lane of traffic maintained in that direction while work occurs.

Additionally, only one portion of Avion Drive either north or south of Century Boulevard will be closed at a time. See Page 2 for information about Cargo & Lot F access when Avion Drive south of Century Boulevard is closed (scheduled for Saturday, August 16 at 10PM through Sunday, August 17 at 11PM).

Flaggers and signage will be in place to facilitate vehicular and pedestrian movements. Please watch for posted signage, use caution when traveling near construction areas, and plan ahead for potential delays.

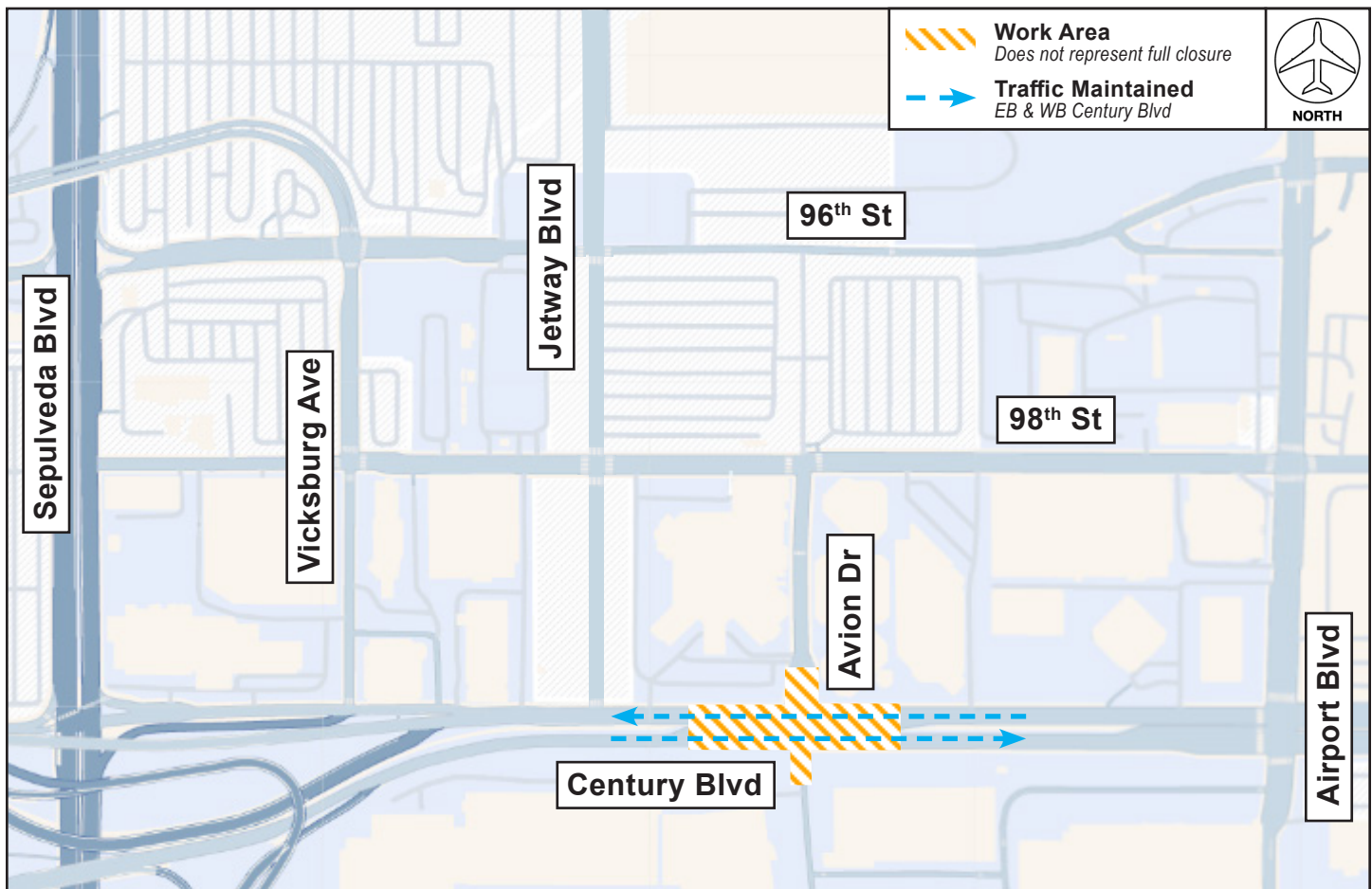

# AVION DRIVE CLOSED

## South of Century Boulevard

Saturday, August 16 at 10PM through Sunday, August 17 at 11PM

### CARGO ACCESS

When Avion Drive south of Century Boulevard is closed, Cargo will use Airport Boulevard to access facilities, and the same route to exit. Flaggers will be in place to direct incoming and outgoing two-way traffic and maintain access at all times.

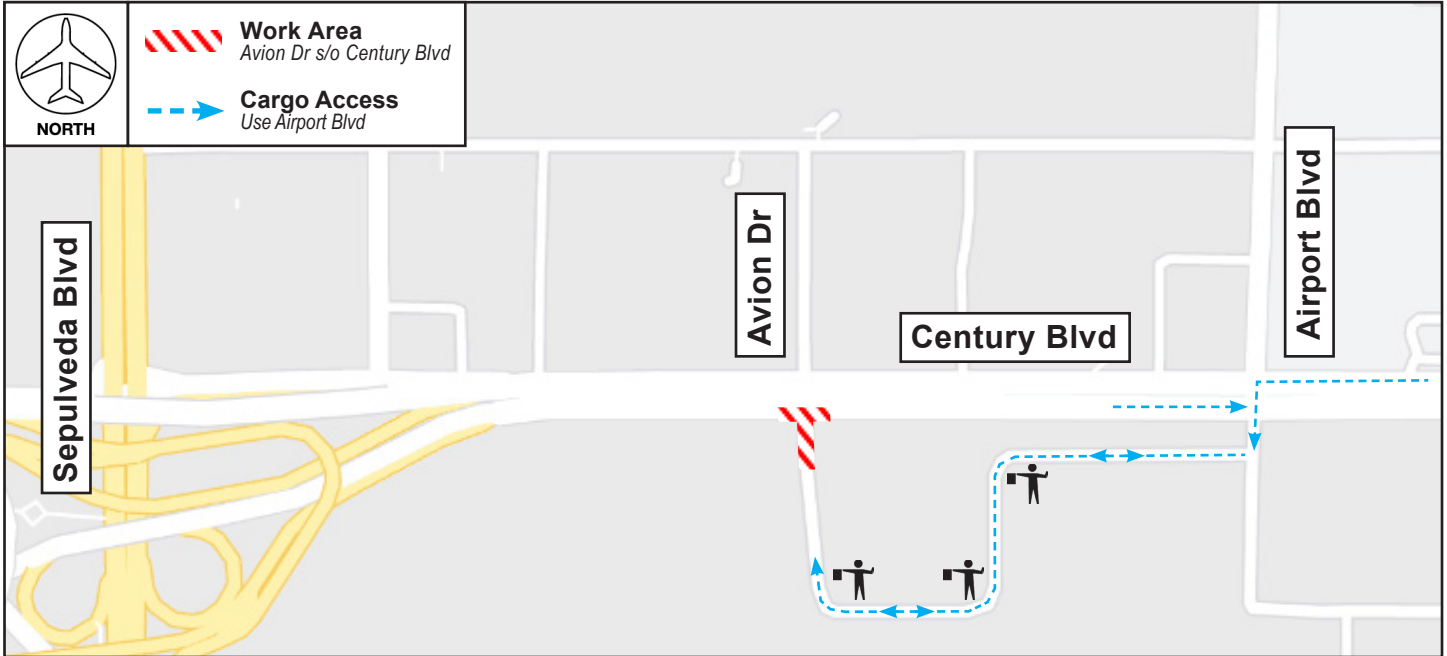

### LOT F ACCESS

When Avion Drive south of Century Boulevard is closed, Lot F will be accessible via Airport Boulevard. Flaggers will be in place to direct two-way traffic and maintain access at all times. Shuttle service will be provided from Lot F to cross Century Boulevard, illustrated below.

